

Base specifications

Use the below specifications to build a concrete base for shed:

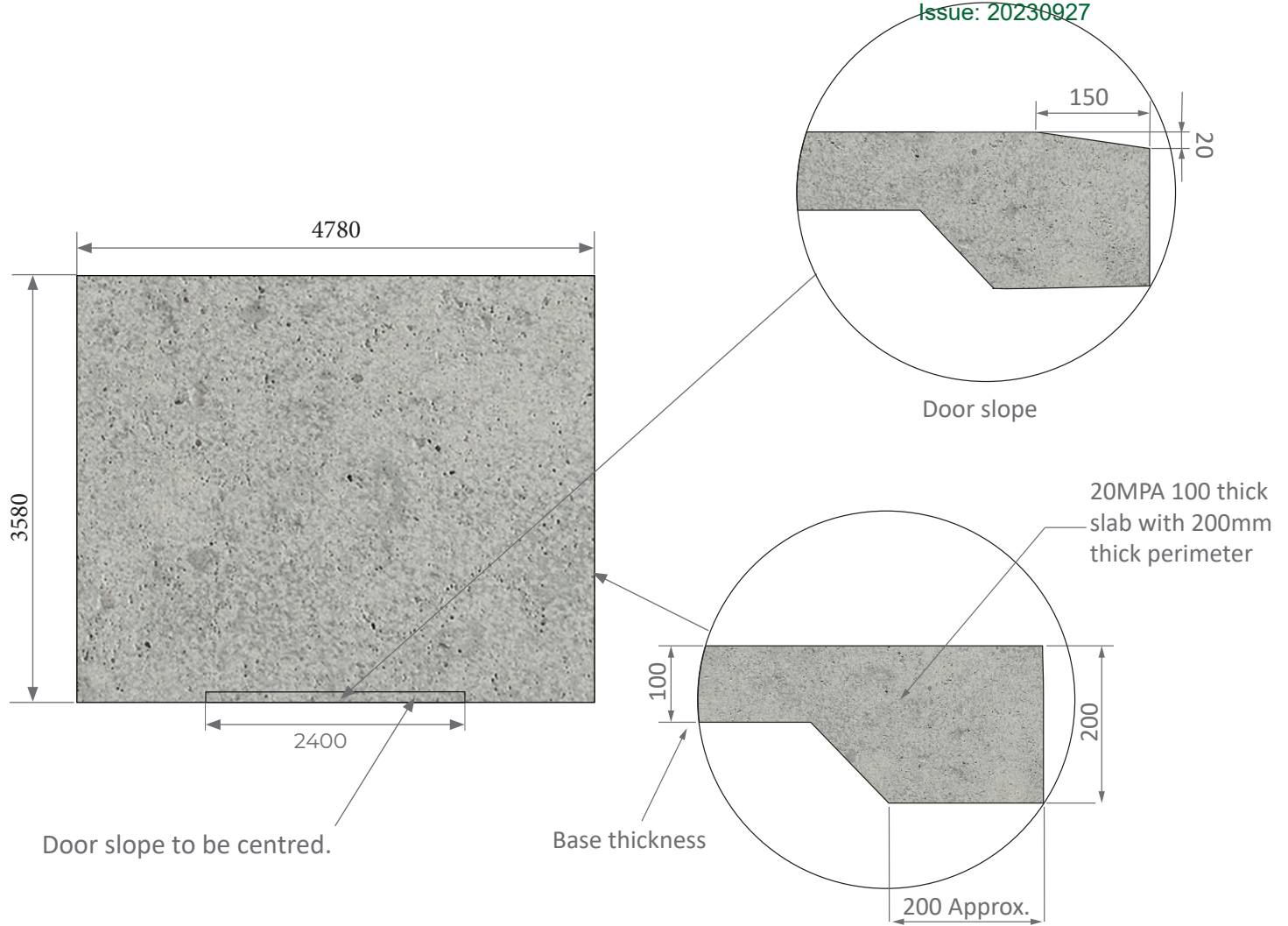

Door slope to be centred.

Base thickness

20MPA 100 thick slab with 200mm thick perimeter

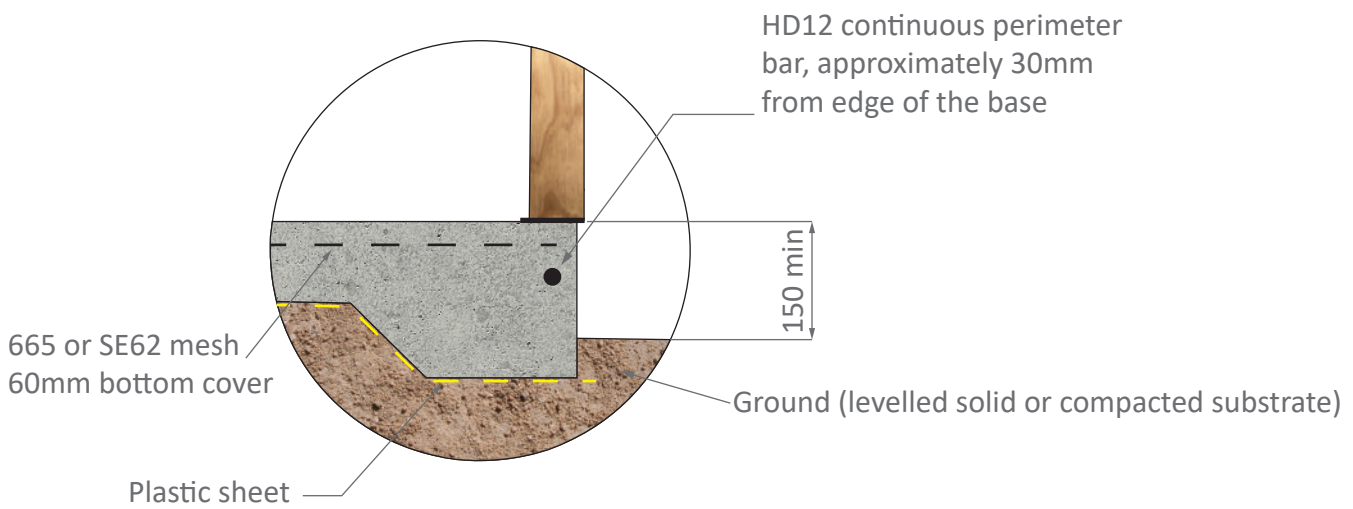

HD12 continuous perimeter bar, approximately 30mm from edge of the base

665 or SE62 mesh
60mm bottom cover

Plastic sheet

Ground (levelled solid or compacted substrate)

- Concrete to NZS 3101

PA door positioning

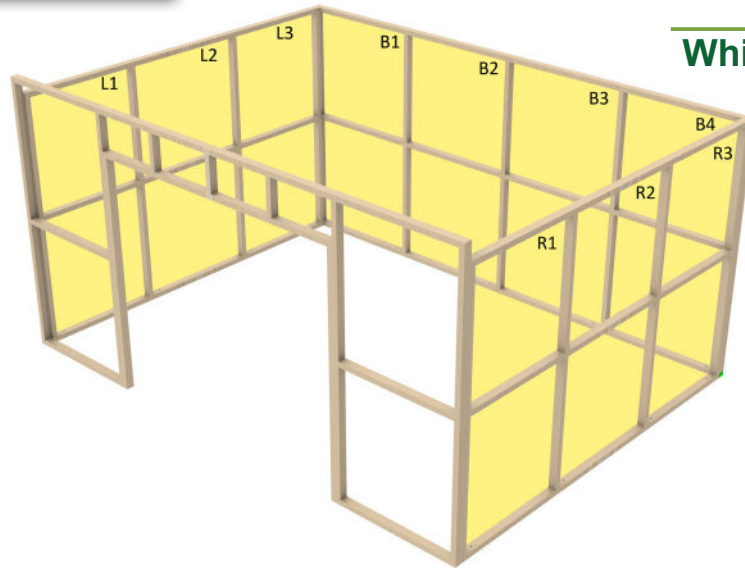

The above image shows the possible positions for PA doors. After selecting the desired position(s), use the dimensions specified in the following image to make PA door slope.

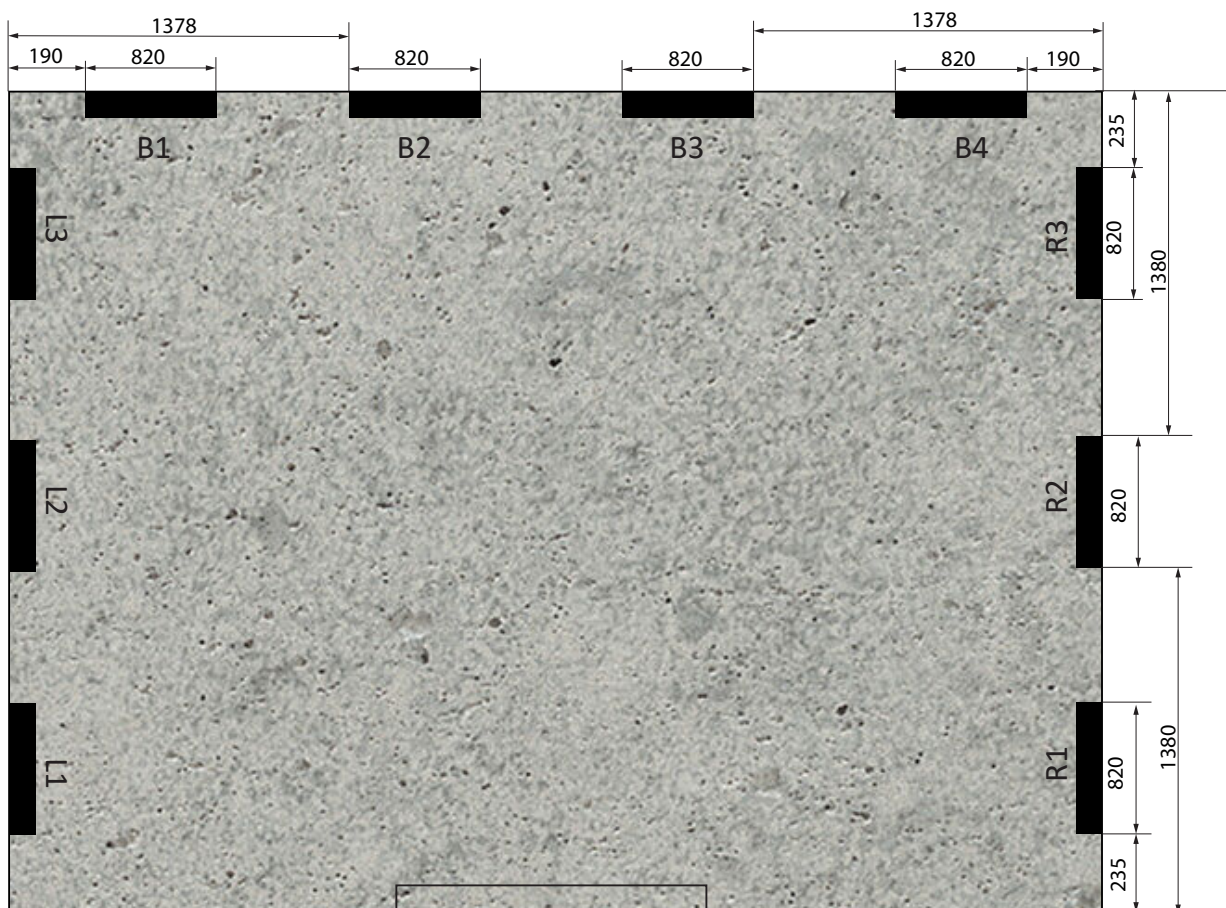

Roller door can be provided in 2 widths: 2400mm & 3000mm.

- **2400mm width roller door possible positions:**

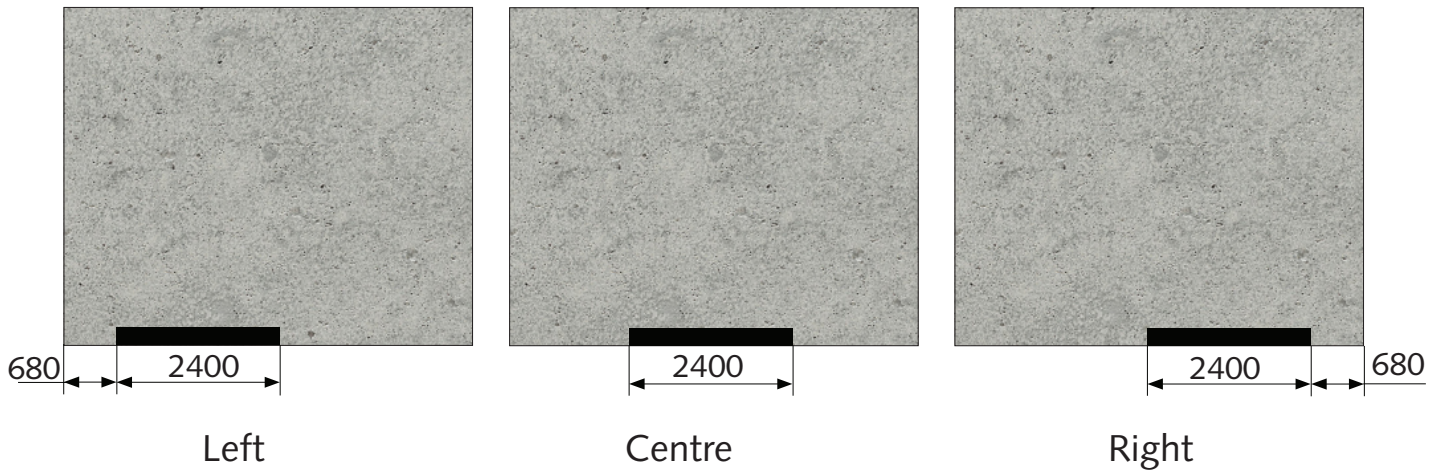

- **3000mm width roller door possible positions:**

